

VERTICAL EXHAUST ROOF MOUNTED

V53

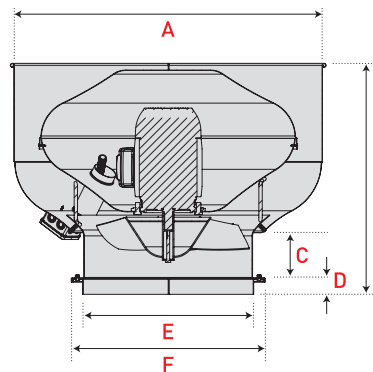

PERFORMANCE DATA & DIMENSIONS



| | | | |
|---|-------|---|-------|
| A | 940mm | D | 45mm |
| B | 750mm | E | 540mm |
| C | 140mm | F | 600mm |

Dimensions may vary within 5% during manufacturing.

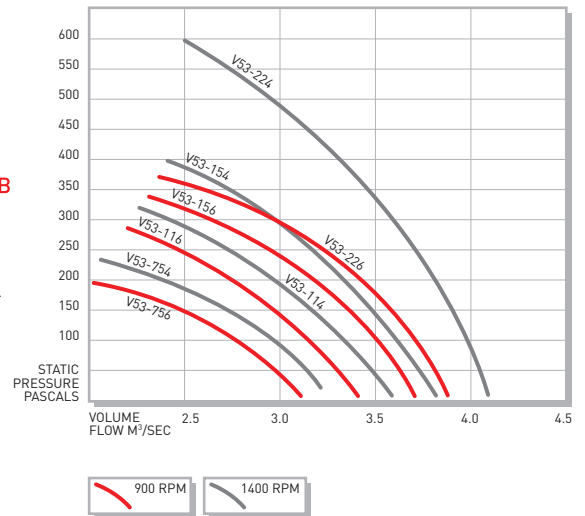

▼ **Type V fans** are designed for use in roof mounted exhaust applications. Each impeller is individually designed and manufactured to precise specifications for maximum airflow at high pressure levels.

▼ **Typical Applications:** Can exhaust air at normal to high temperatures for applications such as commercial kitchens, bakeries, warehouses, storage facilities, spray or welding booths. Can also exhaust toxic or explosive gases in industrial applications with suitable motors.

- Galvanised steel casing.
- Aluminium alloy mixed flow impellers.
- Externally vented motor enclosure.
- Weatherproof.
- Approx Weight: 70-90kg.
- Australian standards compliant.

TECHNICAL DATA

| MODEL NUMBER | FAN SPEED Rev/Min | kW | AMPS +or-10% | VOLTS | NOISE LEVEL [dBA]* | MOTOR SHAFT mm | IP RATING |
|---------------|-------------------|------|--------------|-------|--------------------|----------------|-----------|
| V53-756-SP | 900 | 0.75 | 4.70 | 240 | 55 | 16 | 44 |
| V53-756-3P | 900 | 0.75 | 2.07 | 415 | 55 | 24 | 55 |
| V53-754-SP*** | 1400 | 0.75 | 4.30 | 240 | 68 | 16 | 44 |
| V53-754-3P | 1400 | 0.75 | 1.79 | 415 | 68 | 19 | 55 |
| V53-116-3P | 900 | 1.10 | 3.38 | 415 | 58 | 24 | 55 |
| V53-114-3P | 1400 | 1.10 | 2.43 | 415 | 70 | 24 | 55 |
| V53-156-3P | 900 | 1.50 | 3.70 | 415 | 59 | 28 | 55 |
| V53-154-3P | 1400 | 1.50 | 3.20 | 415 | 72 | 24 | 55 |
| V53-226-3P | 900 | 2.20 | 5.2 | 415 | 60 | 28 | 55 |
| V53-224-3P | 1400 | 2.20 | 4.70 | 415 | 73 | 28 | 55 |
| V53-404-3P | 1400 | 4.0 | 8.25 | 415 | 74 | 28 | 55 |

* Approx noise level @ 3 meters (dBA)

** Variable speed controllable with Variable Speed Switch (VSS)

*** Two Speed motors, controllable with two speed switch (2SS). Available on request.

Energy Efficiency, NCC/BCA Vol. 1, Section J Compliant + 2019

NOTE: All fans may be controlled with a Cyclo Variable Speed Drive or other control switches. We recommend all speed control units and switches to be used only with products supplied by Cyclo Fans.

ORDERING CODE

| V 5 3 - 7 5 6 - 3 P * | | | | |
|--------------------------|-------|-------------|---------|-------------------------|
| TYPE OF FAN | SIZE | MOTOR POWER | POLE | ELECTRICAL REQUIREMENTS |
| V: VERTICAL EXHAUST | 250MM | | 4 POLE: | SP: SINGLE PHASE |
| A: AXIAL EXHAUST | 300MM | .18kW | 1400RPM | 3P: THREE PHASE |
| CAV: FOOD TRUCK EXHAUST | 380MM | .37kW | OR | |
| SAV: SUPPLY AIR VERTICAL | 460MM | .55kW | 6 POLE: | |
| SAA: SUPPLY AIR AXIAL | 530MM | .75kW | 900RPM | |
| | 610MM | 1.1kW | | |
| | | 1.5kW | | |
| | | 2.2kW | | |
| | | 4.0kW | | |

* EXAMPLE ONLY

CYCLO INTERNATIONAL PTY LTD

75 Northgate Drive,
Thomastown Victoria, 3074.

Telephone: +61 3 9383 6668

Email: sales@cyclomade.com.au

www.cyclomade.com.au